

CERTIFIED LAND CORNER RECORDATION

T-17-N, R-60-W DESCRIPTION OF CORNER EVIDENCE FOUND, AND ORIGINAL RECORD (If known)

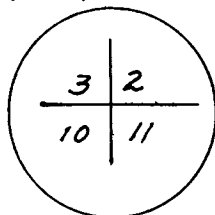

No evidence of G.L.O. Monument described as a limestone 16" X 12" containing standard markings.

DESCRIPTION OF MONUMENT AND ACCESSORIES ESTABLISHED TO PERPETUATE THE ORIGINAL LOCATION OF THIS CORNER:

with Aluminum Cap

Set a No. 5 Rebar 4" ± below grade of Trail Road. location at center of Trail Road (East-West) which serves as east-west property boundary and by single proportional measure to determine east-west position only.

SKETCH, WITH COURSE AND DISTANCE TO ADJACENT CORNER IF DETERMINED IN THIS SURVEY.
(May Sketch or Paste Reproduction on Reverse Side.)

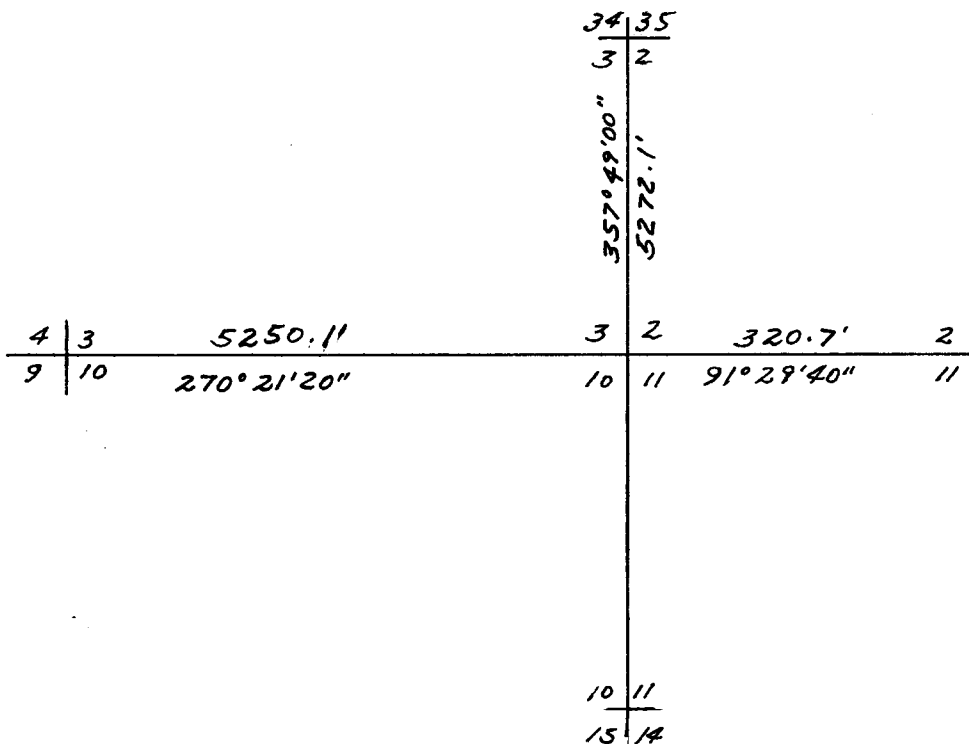

I, Edward C. Fry certify that I have carefully performed or reviewed the work done on the diagrammed corner as reported on this recordation form and approve the same.

1-27-81

Edward C. Fry
Signature of Surveyor

P.E./L.S. 662
Registration No.

STATE OF WYOMING,
Office of Clerk and Recorder,
County of _____

606831

This "corner record" was filed for record on the _____ day of JAN 29 1981, 19____, was noted on the cross-index plat and is assigned page No. _____, in book No. _____.

James C. Witzel
County Official

Cross Index No. _____ T. _____ R. _____ Mer.
 _____ T. _____ R. _____ Mer.
 _____ T. _____ R. _____ Mer.
 _____ T. _____ R. _____ Mer.
 _____ T. _____ R. _____ Mer.
 _____ T. _____ R. _____ Mer.
 _____ T. _____ R. _____ Mer.